

## **CastExpo 2025** *(Point of Reference)*

- **Registration:** Level 4 (main street level & entrance into Building A)
- **Keynotes:** Level 4
- **Technical Sessions:** Level 3 (middle level of Building A)
- **Exhibit Hall:** Level 1 (lowest level of Building A)

# **Building A East Plaza Outdoor Digital Billboard**

East Plaza Digital  
Outdoor Billboard

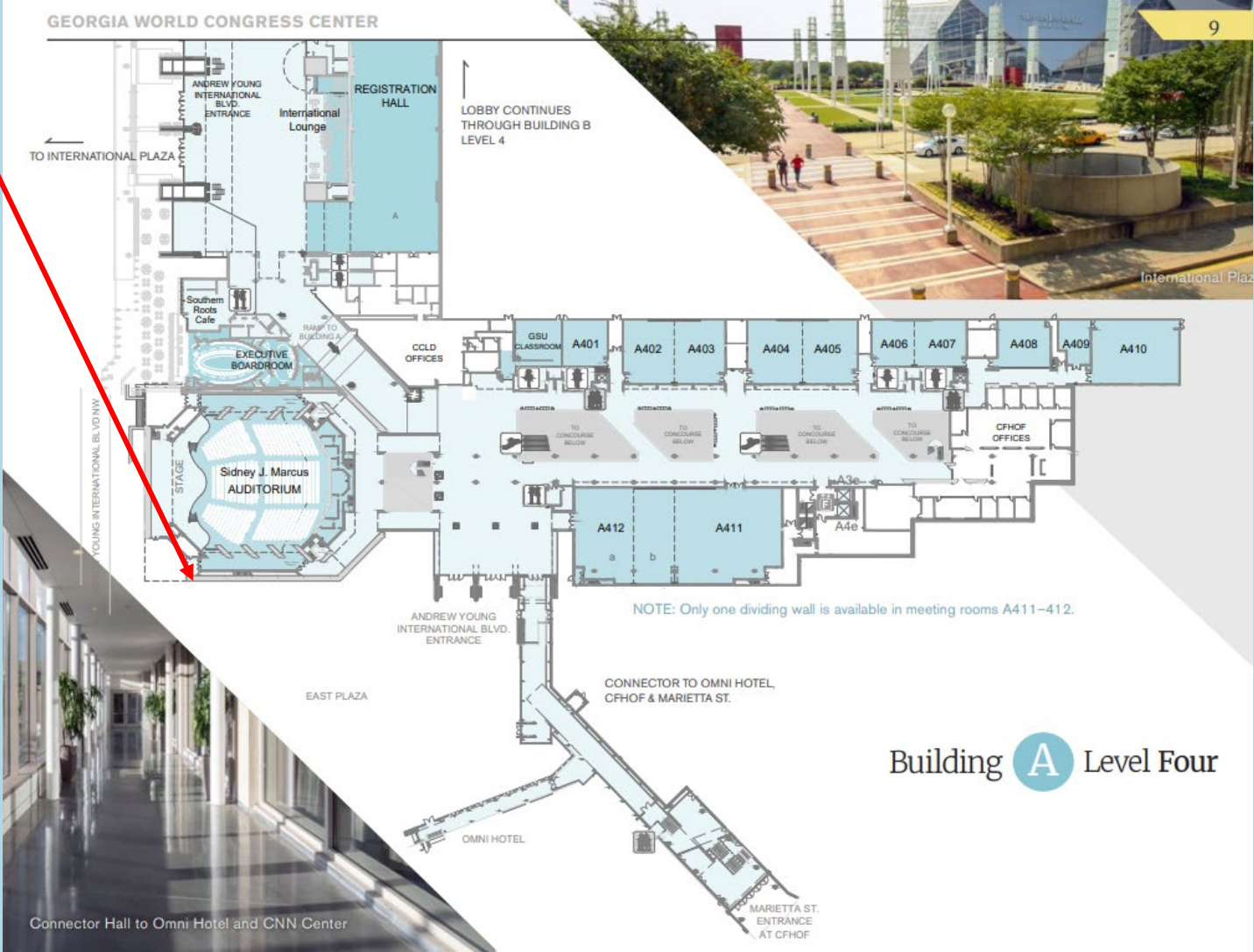



## East Plaza Billboard (Building A)

Side of Building A 48' x 14'

Specs: (900x240 @96dpi JPG/MP4)

10 seconds loop for duration of event out of 120 loop

**Cost: \$1750 Available: 4**

# **Building A East Plaza Entry**

## **Outdoor LED and Vinyl Banners**



Outdoor LED

Outdoor Banners

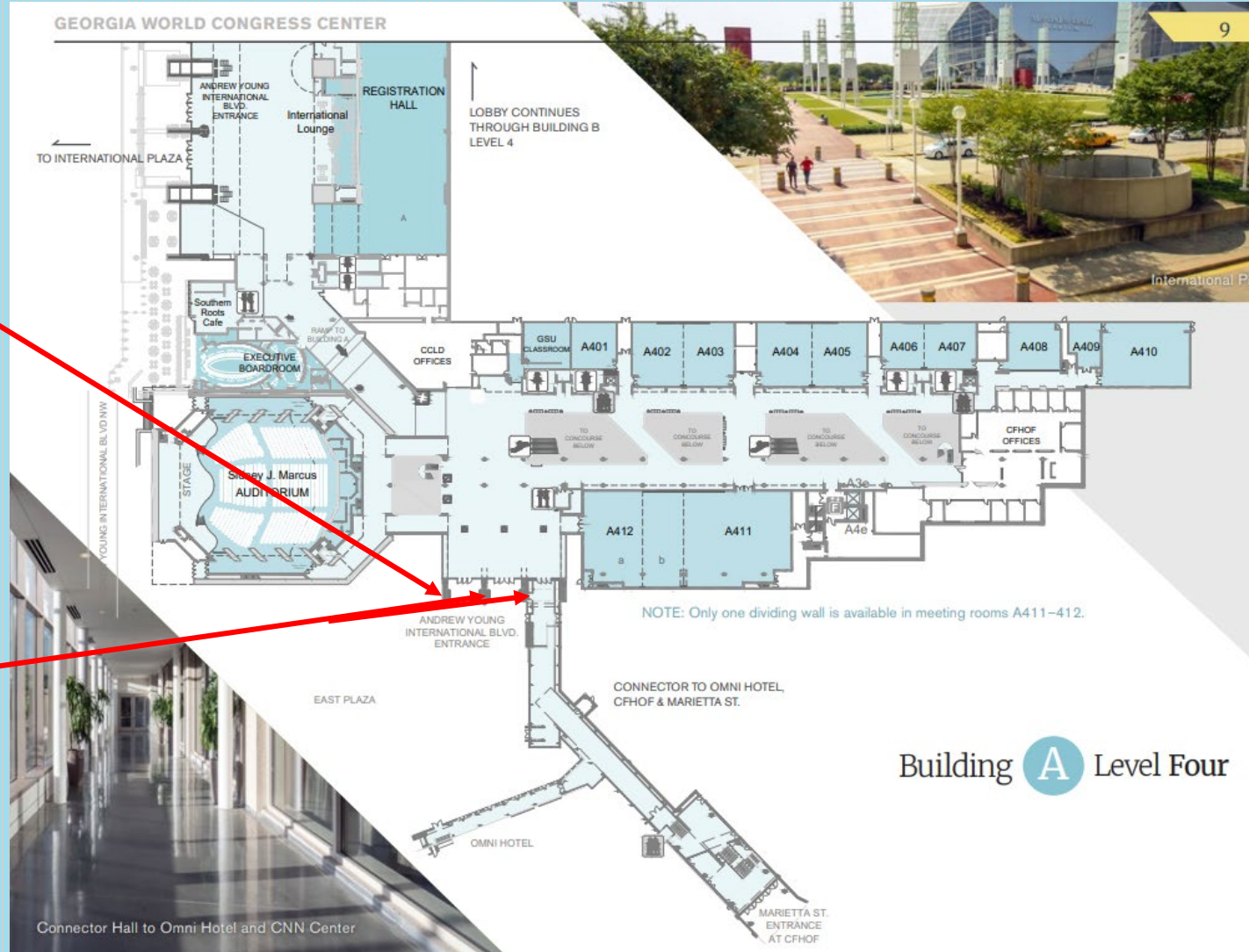



- **LED 1-sided**

Specs: 1080x1920 Portrait JPG/MP4

6.5 ftW x 10 ftH

**Cost: \$2,500 Available: 1**

- **4 Vinyl Banners 1-sided**

60"x96"

**Cost: \$1350 each Available: 4**

Specs: 60" x 96" Hi Res PDF  
(production, install, removal)

Choose From: Looking at the door Right or Left side  
VB1R, VB1L, VB2R, VB2L

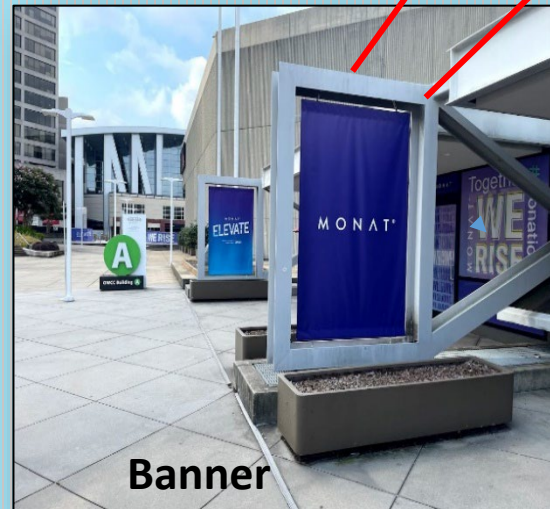

# Building A Door Clings



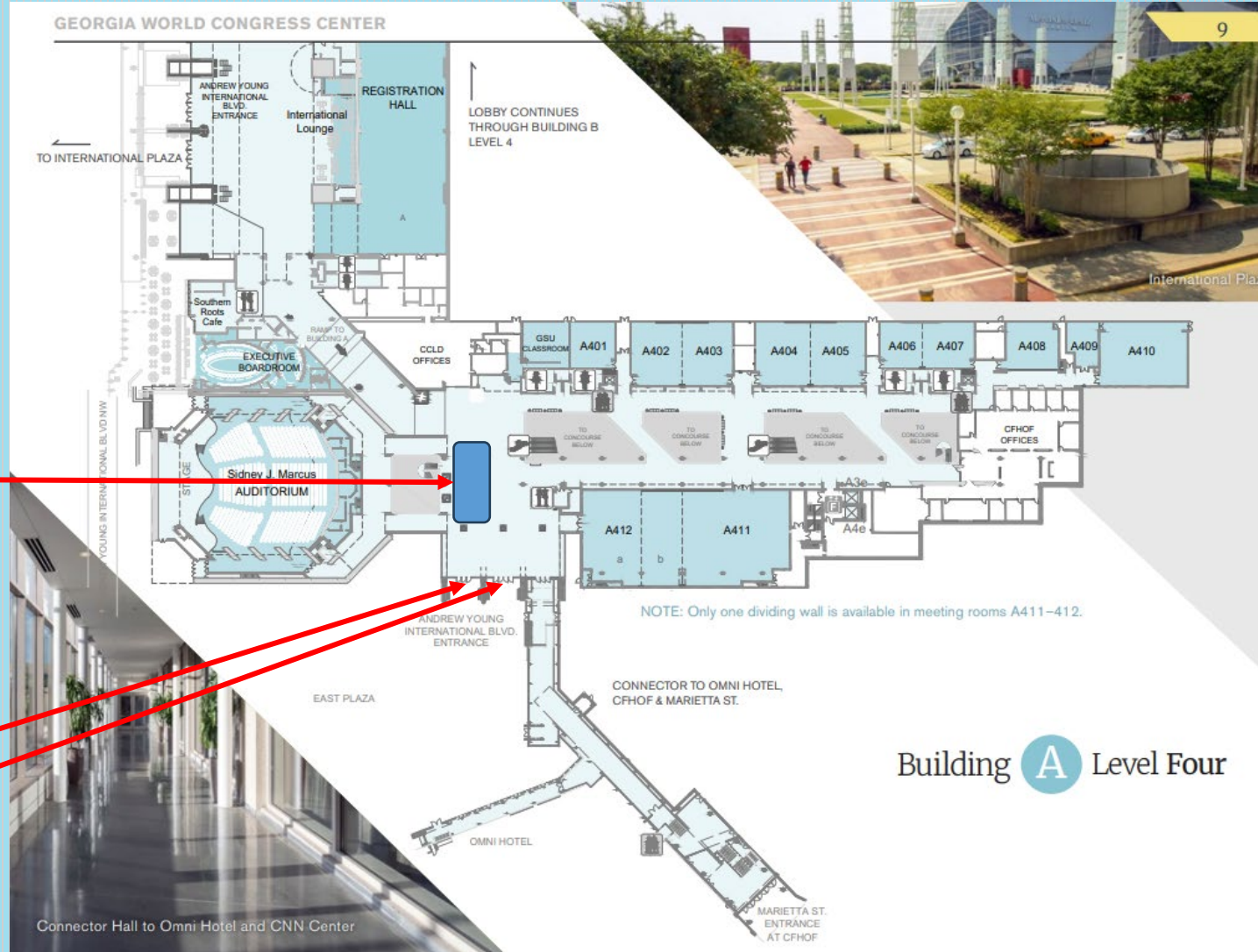

CastExpo  
Registration

East Plaza Door  
Clings on doors  
into Registration  
from Hotels

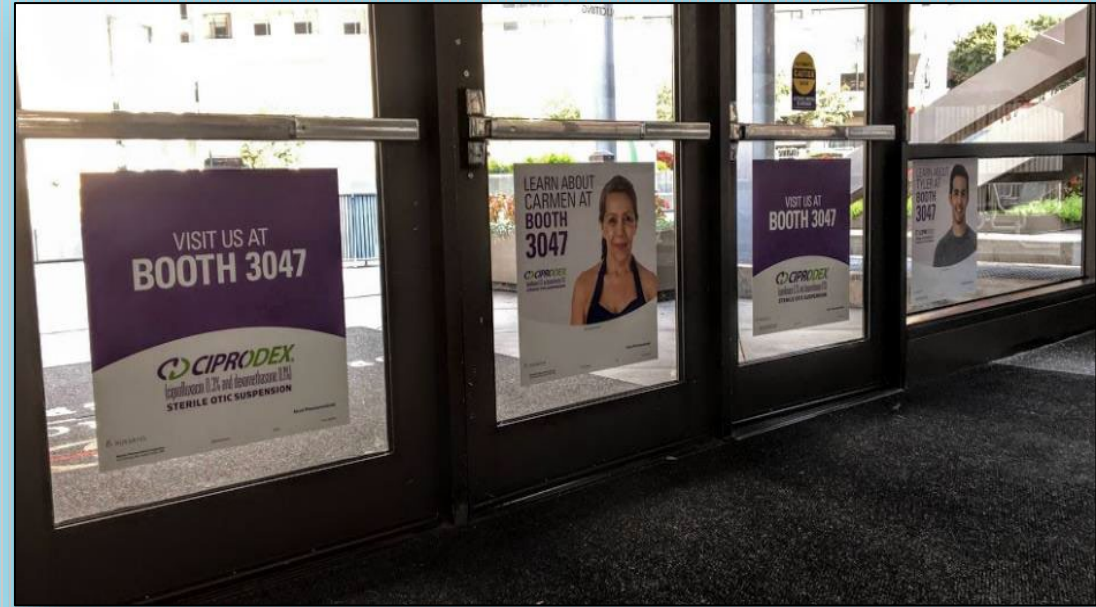

## Door Clings on Building A doors from East Plaza Entrance to Registration

Specs: 24" x 24" (Double-Sided)

Cost: \$300 each door **Available: 7**  
(production, install, removal)



# **Building A Air Return Column by Registration**



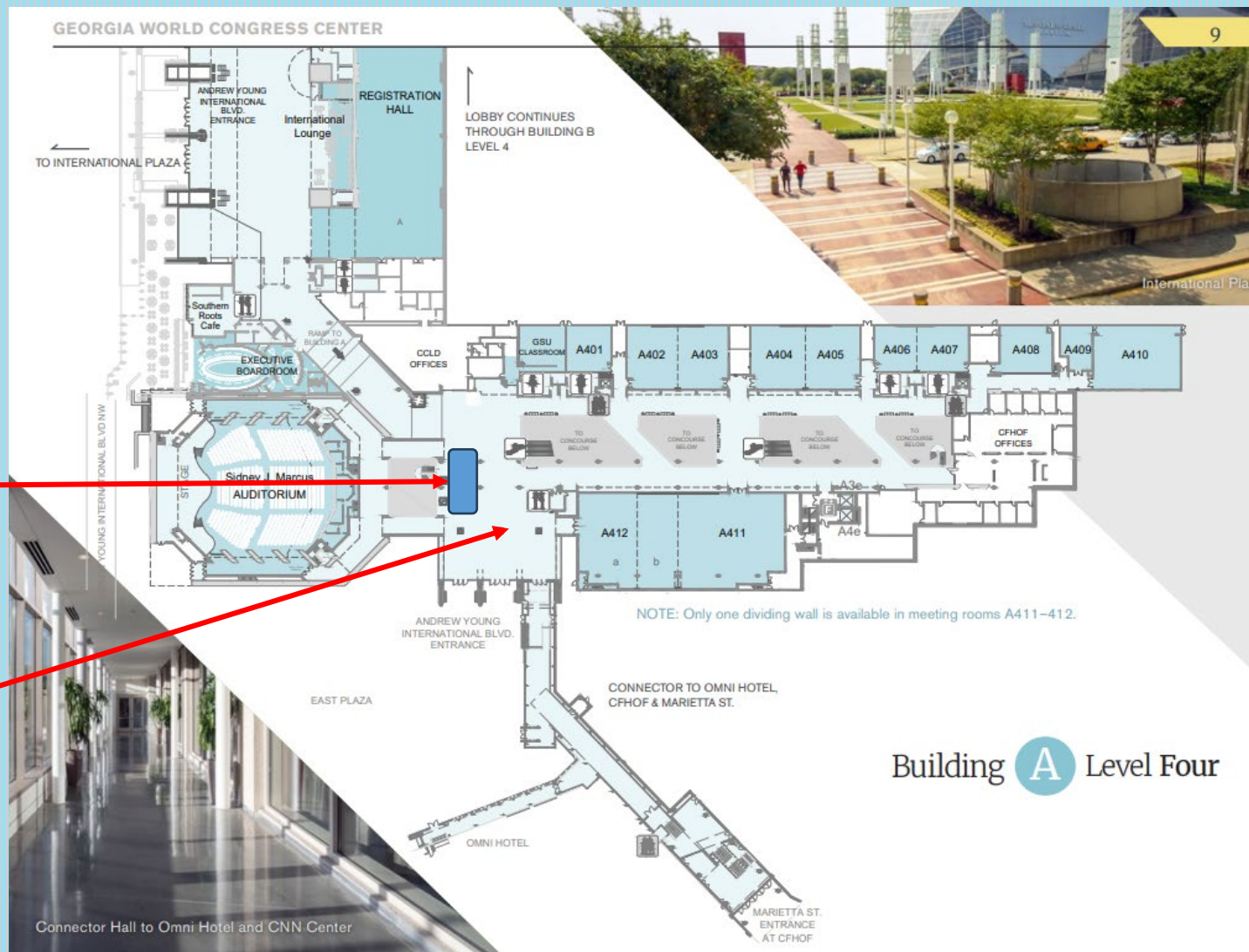

CastExpo  
Registration

Air Return Column  
A1



## Building A Lobby

Air Return Column (One 4-sided cube)

Specs: 50.5" W x 76.75" H Hi Res PDF

**Cost:** \$2000 (All 4 sides) **Available:** 1  
(production, install, removal of foamboard)

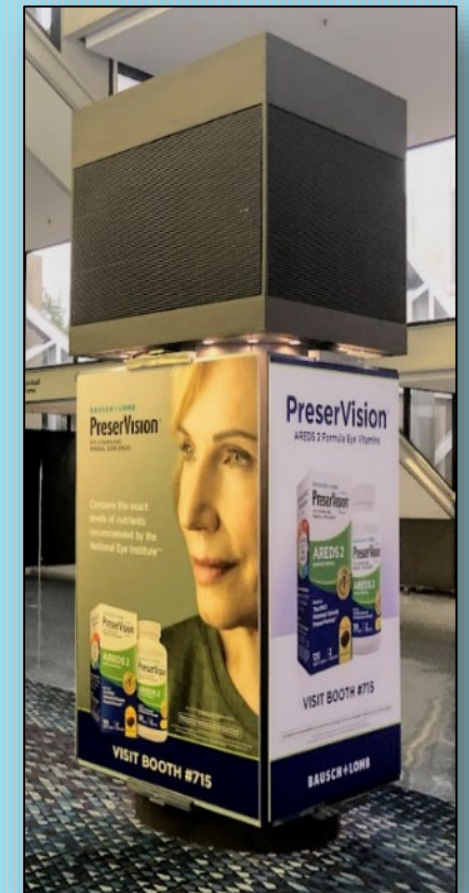

# **Building A LED Wall Lobby/Registration**

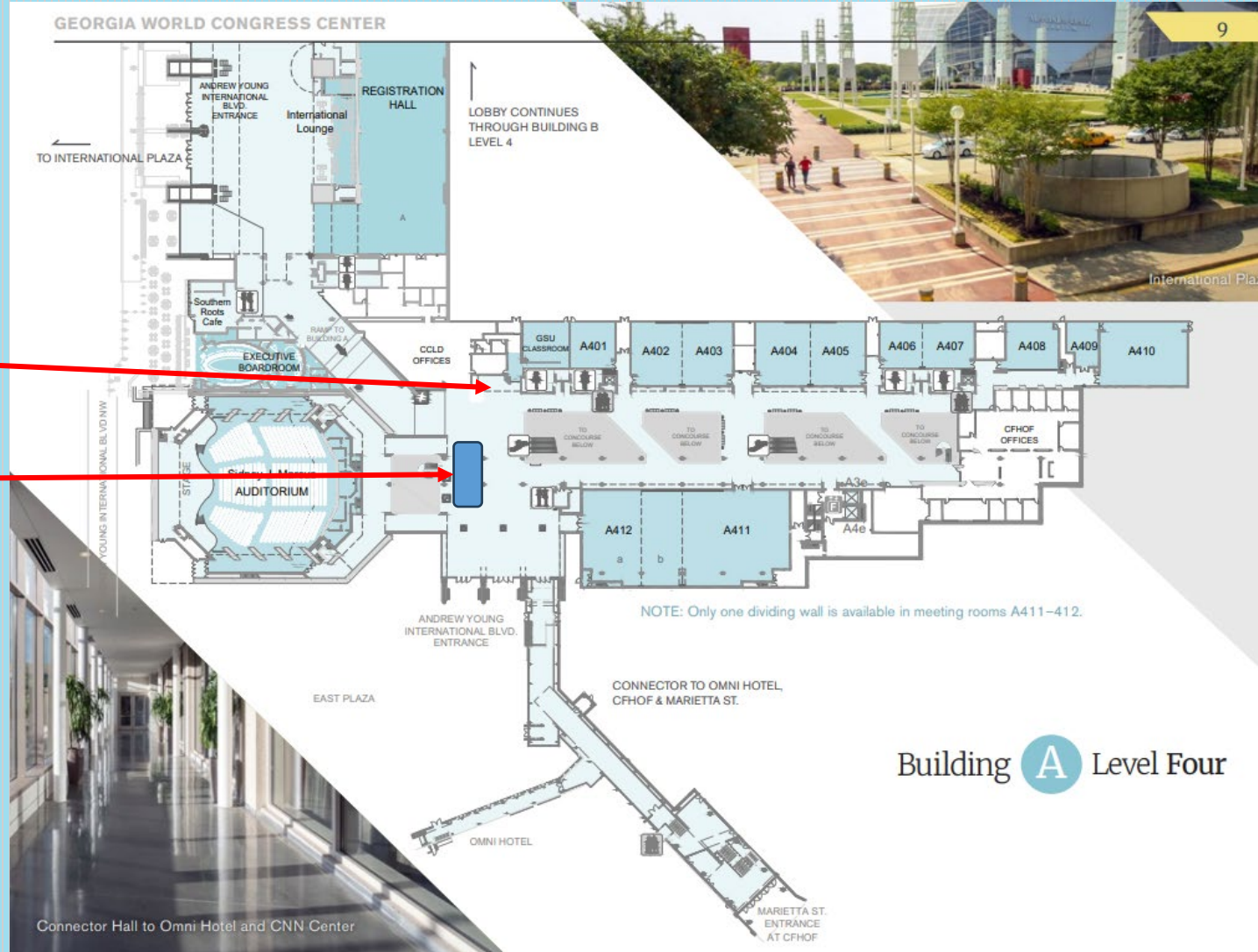

LED Wall

CastExpo  
Registration



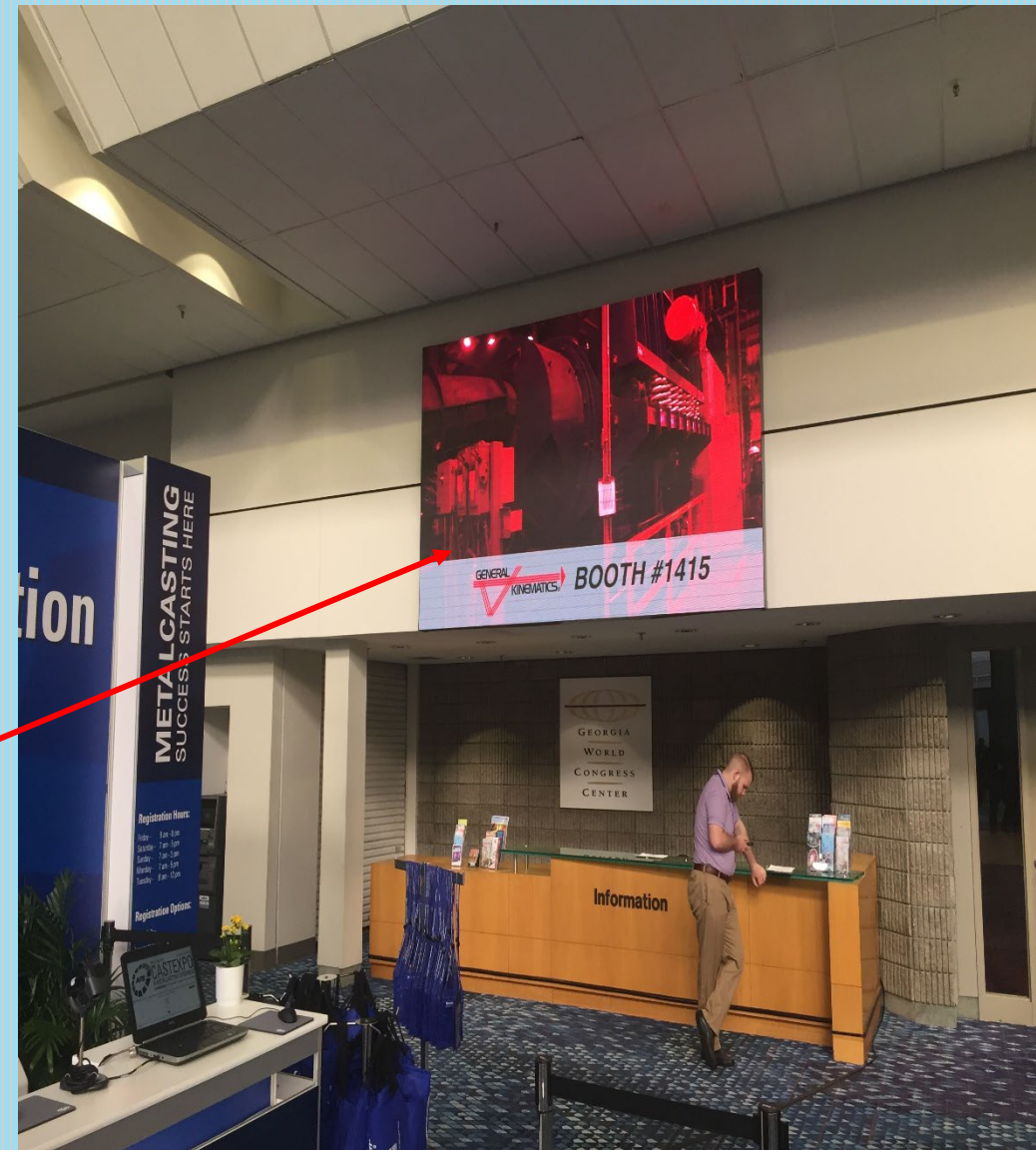

## LED Wall

Specs: 10.5' x 6.5' (1920x1080 @96 dpi JPG/MP4)

10 second loop out of 180 loop

**Cost: \$1200 Available: 10**

Duration of event



# Building A Monitors

## STREET LEVEL 4

Blue Box: CastExpo Registration Area

Purple Box: CastExpo Keynote Room

Yellow Oval: Monitor Locations

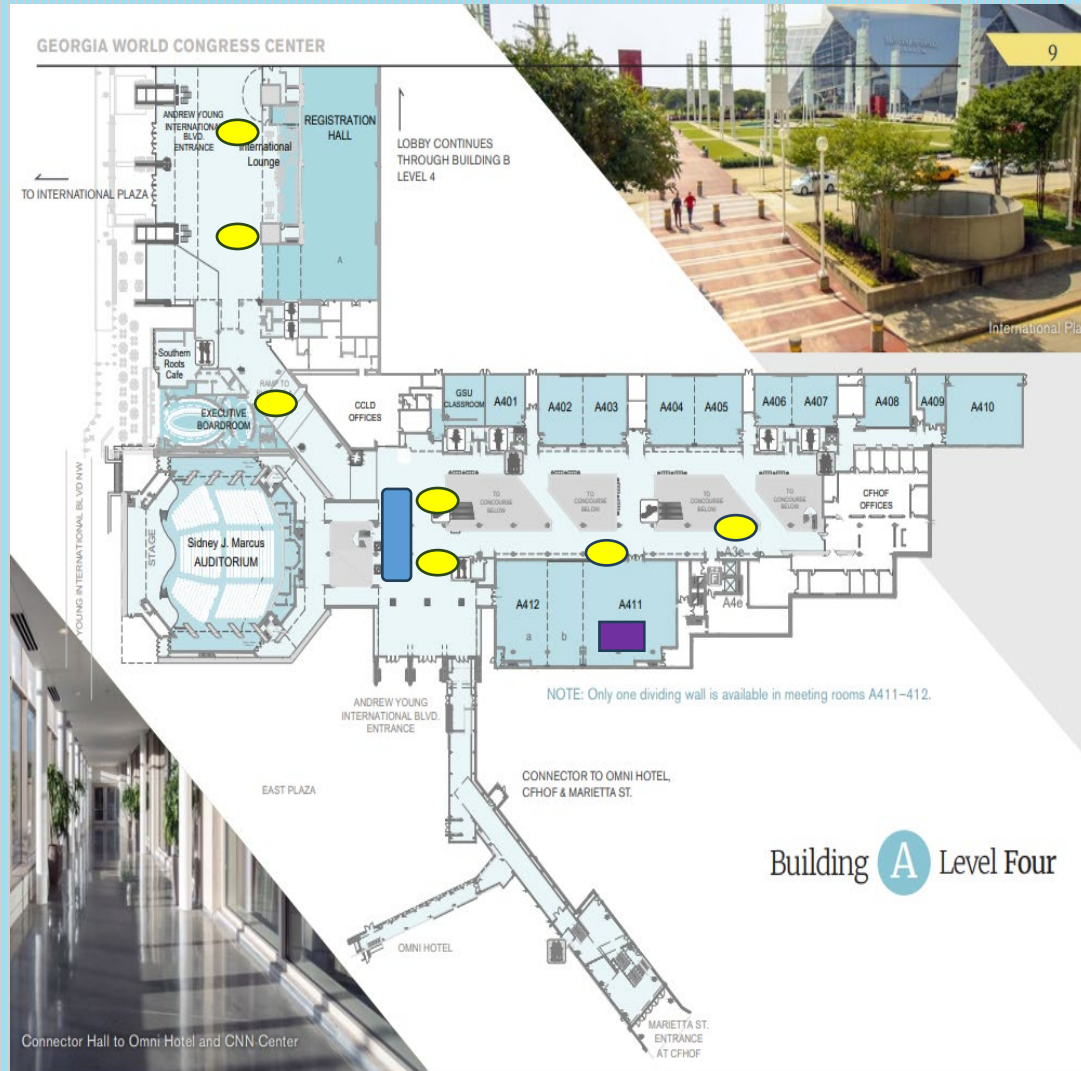

## TECHNICAL SESSION LEVEL 3

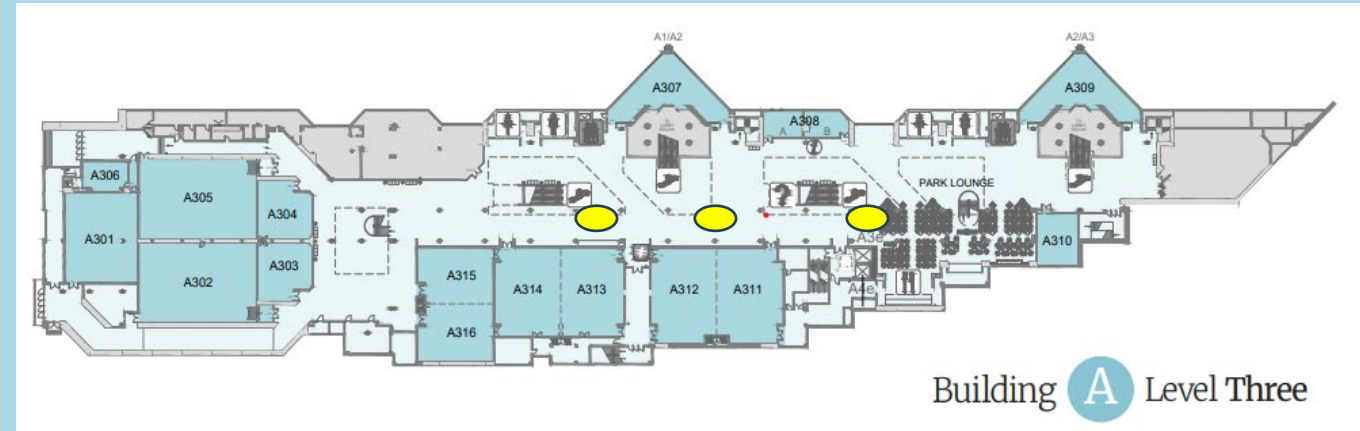

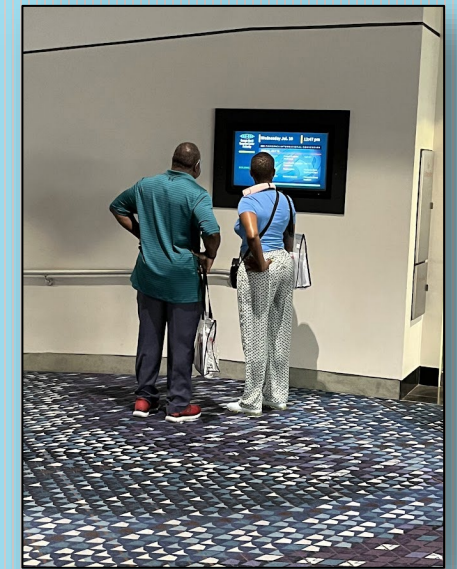
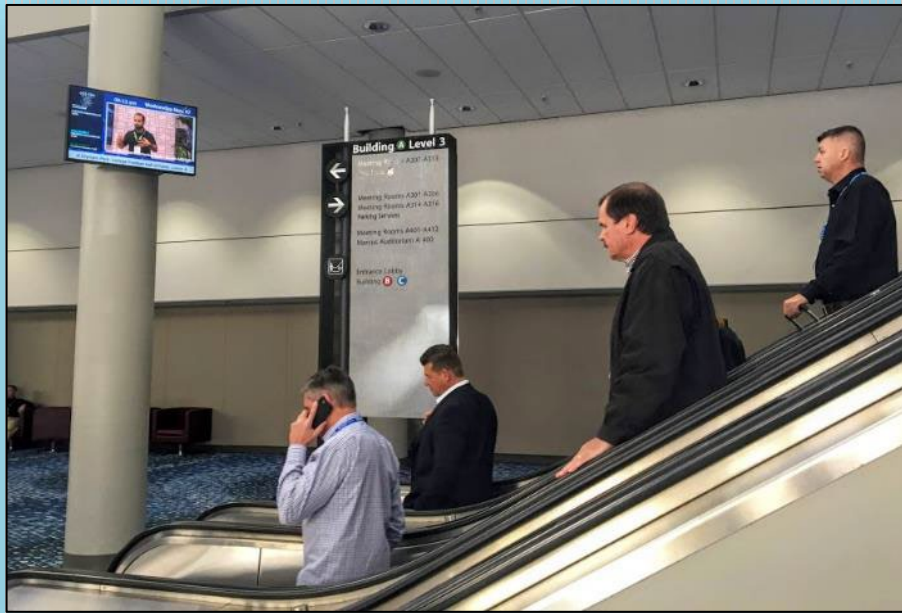

## Building A Monitors (10)

Located on all levels

Specs: 1920x1080 @96 JPG/MP4

10 seconds out of 180 second loop

**Cost: \$1500 Available: 10**

Duration of event



# **Building A**

## **Escalator Runners**



## STREET LEVEL 4

Blue Box: CastExpo Registration Area

Purple Box: CastExpo Keynote Room

**Green Oval (ESC1) :** 1<sup>st</sup> Escalator starting at Level 4 down to Level 3

**Rust Oval (ESC2):** 2<sup>nd</sup> Escalator starting at Level 4 down to Level 3

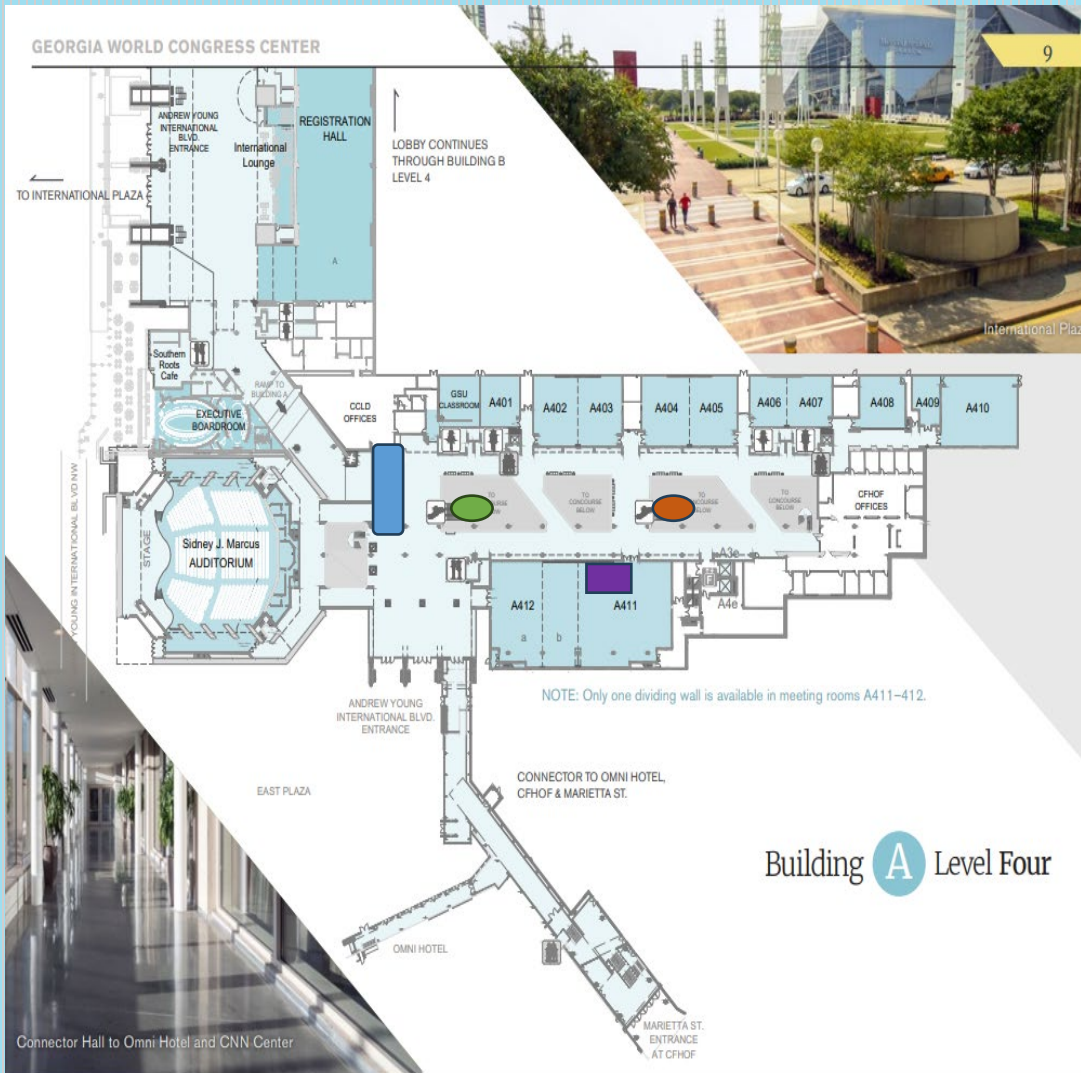

## TECHNICAL SESSIONS LEVEL 3

Green Oval: 1<sup>st</sup> Escalator from Level 4 ending at Level 3

Rust Oval : 2<sup>nd</sup> Escalator from Level 4 ending at Level 3

**Gold Oval (ESC3):** 1<sup>st</sup> Escalator starting at Level 3 down to Level 1

**Gray Oval (ESC4):** 2<sup>nd</sup> Escalator starting at Level 3 ending at Level 1



## EXHIBIT HALL LEVEL 1

Gold Oval: 1<sup>st</sup> Escalator from Level 3 ending at Level 1

Gray Oval: 2<sup>nd</sup> Escalator from Level 3 ending at Level 1

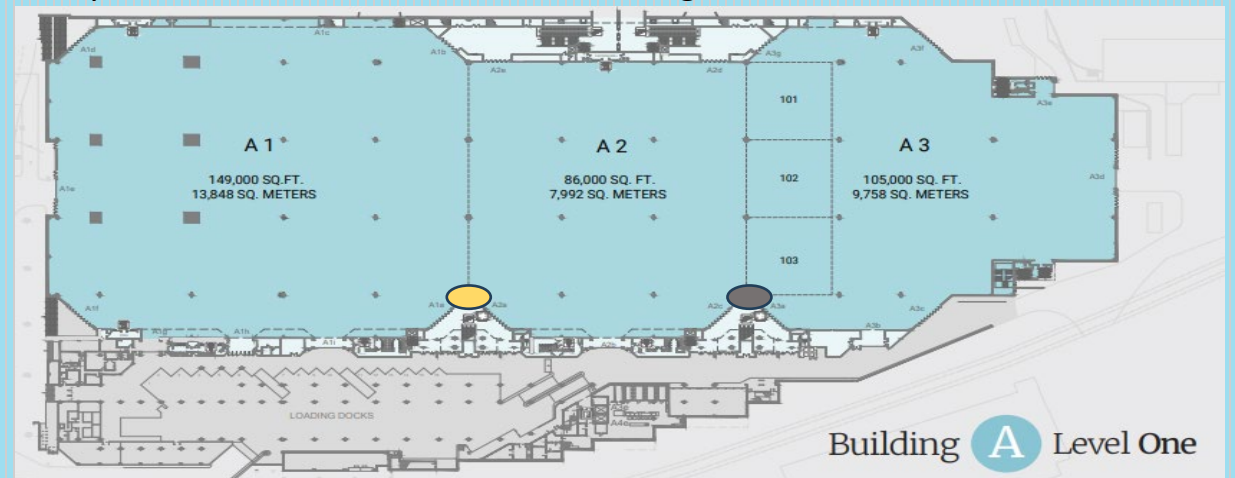

## Escalator Runners

One continuous sheet with safety-puck holes pre-cut  
Building A – (One-piece 18mm PVC) **Cost:** \$1900  
each side **Available:** 8 Specs: 14.5 in. x 624 in.  
(production, installation and removal)

Choose From: Looking Down

**ESC1** (Right side goes down) or (Left side goes up)

**ESC2** (Right side goes down) or (Left side goes up)

**ESC3** (Right side goes down) or (Left side goes up)

**ESC4** (Right side goes down) or (Left side goes up)

