

Building A

Escalator Runners

STREET LEVEL 4

Blue Box: CastExpo Registration Area

Purple Box: CastExpo Keynote Room

Green Oval (ESC1) : 1st Escalator starting at Level 4 down to Level 3

Rust Oval (ESC2): 2nd Escalator starting at Level 4 down to Level 3

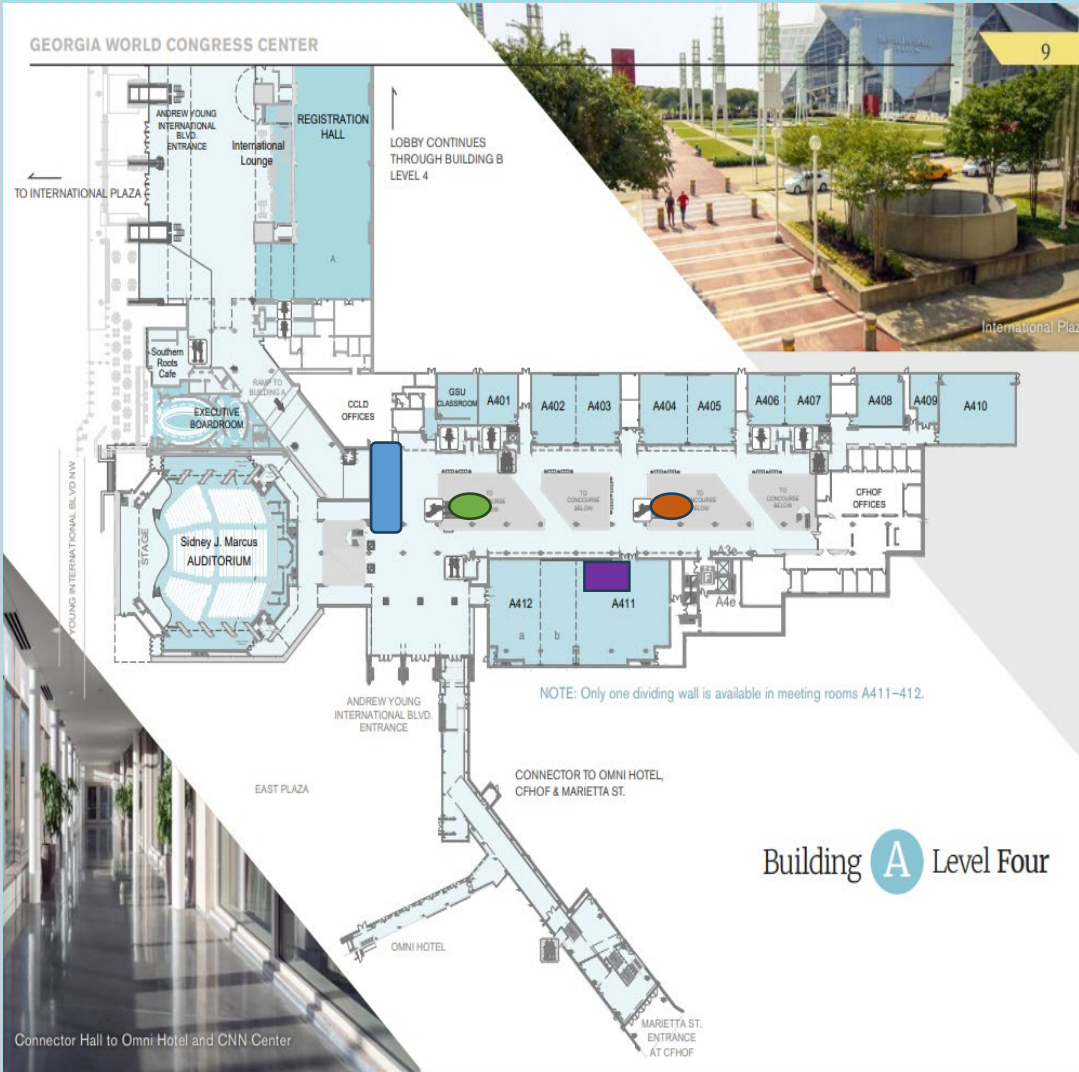

TECHNICAL SESSIONS LEVEL 3

Green Oval: 1st Escalator from Level 4 ending at Level 3

Rust Oval : 2nd Escalator from Level 4 ending at Level 3

Gold Oval (ESC3): 1st Escalator starting at Level 3 down to Level 1

Gray Oval (ESC4): 2nd Escalator starting at Level 3 ending at Level 1

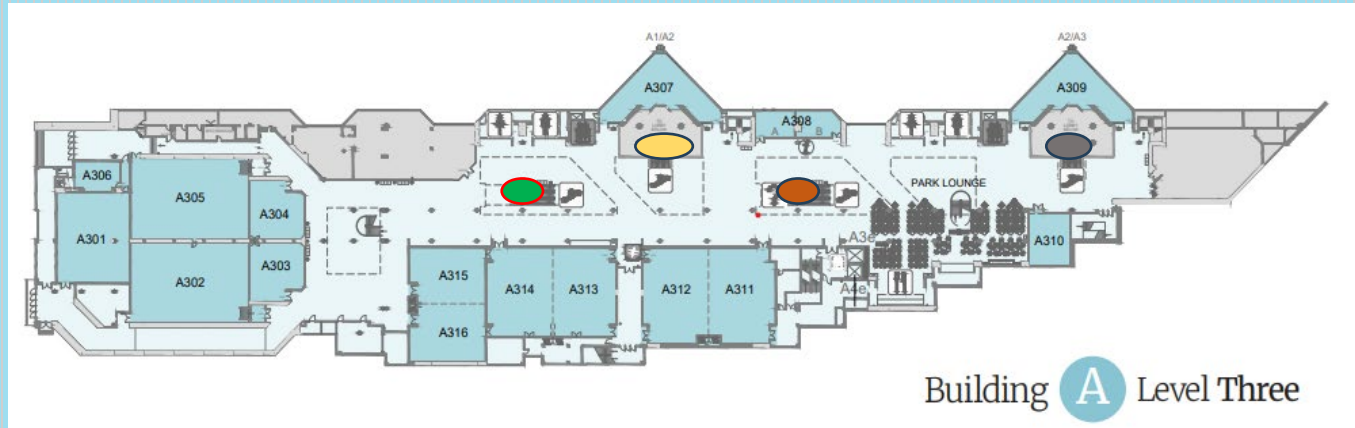
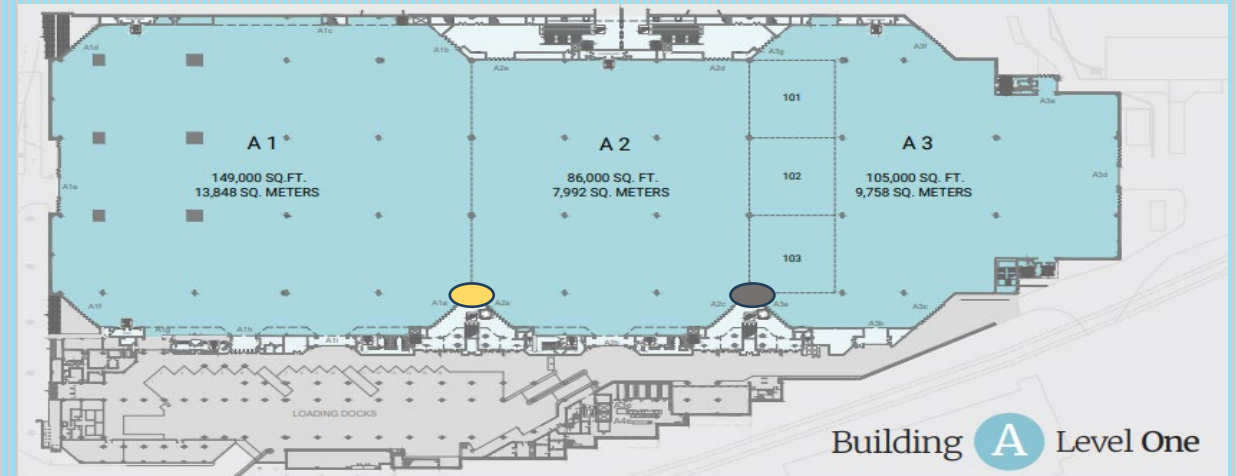

EXHIBIT HALL LEVEL 1

Gold Oval: 1st Escalator from Level 3 ending at Level 1

Gray Oval: 2nd Escalator from Level 3 ending at Level 1



Escalator Runners

One continuous sheet with safety-puck holes pre-cut
Building A – (One-piece 18mm PVC) **Cost:** \$1900
each side **Available:** 8 Specs: 14.5 in. x 624 in.
(production, installation and removal)

Choose From: Looking Down

ESC1 (Right side goes down) or (Left side goes up)

ESC2 (Right side goes down) or (Left side goes up)

ESC3 (Right side goes down) or (Left side goes up)

ESC4 (Right side goes down) or (Left side goes up)

